

SE GROUND SCREW

Ground screws offer a sophisticated alternative to traditional concrete-based mounting systems. Manufactured primarily from hot-dip galvanized steel, these helical anchoring solutions provide robust, versatile support for solar infrastructure across diverse terrains.

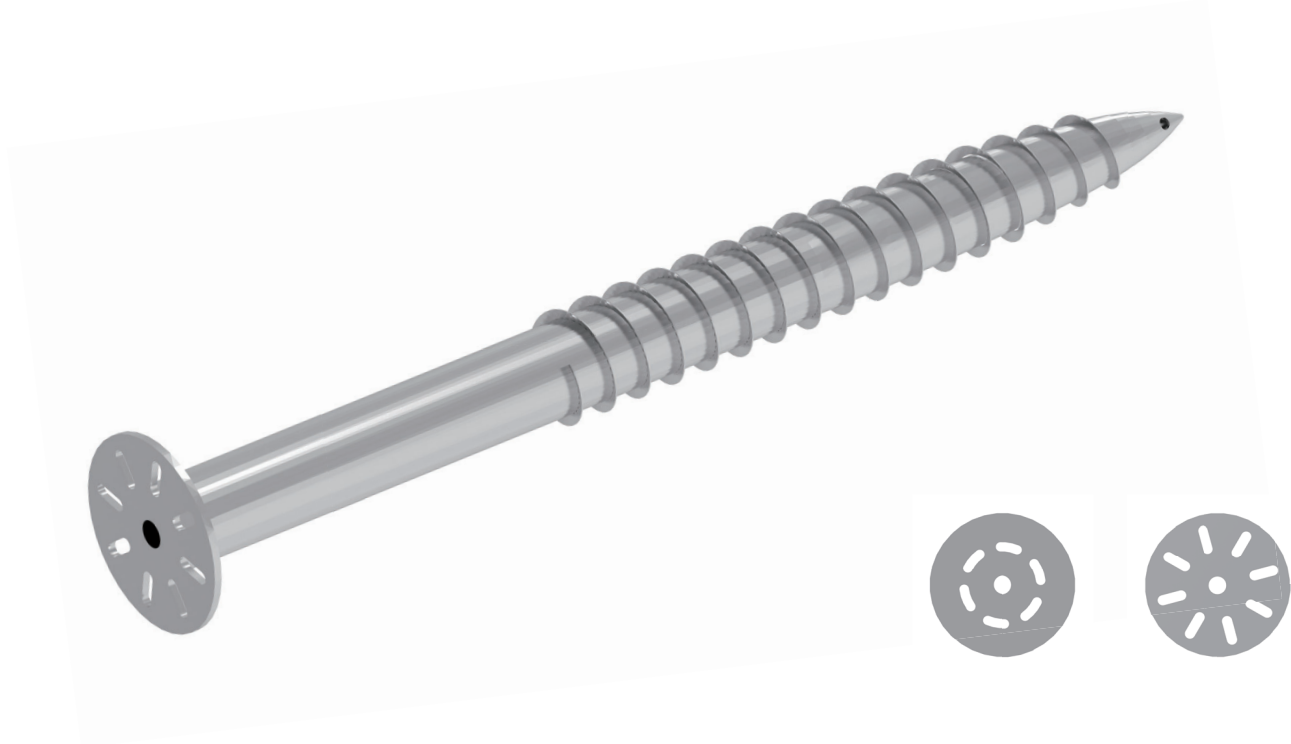

STANDARD SPECIFICATION

Name of product: SE GROUND SCREW (with flange)
Product Number: SE-GS76-1600F-T3.0
Material: Carbon Steel (Q 2358/ISO 630 Fe360D)
Surface Treatment: Hot Dip Galvanizing (DIN EN ISO 1461)
Galvanized Layer 80µm or more
Length: 1600mm
Pile Pipe Outer Diameter: 76mm
Pile Pipe Inner Diameter: 70mm
Pile Pipe Thickness: 3.0mm
Flange Diameter: 200mm

*length, thickness, pile diameter can be customized



When choosing the quantity and size of ground screws, it's important to consider the effects of various loads—such as wind, snow, and seismic activity—on the ground piles. The selection should be based on soil hardness determined from previous soil investigations and site surveys. The table below provides reference values for the pull-out and compression forces of spiral ground piles of varying lengths under different soil conditions.

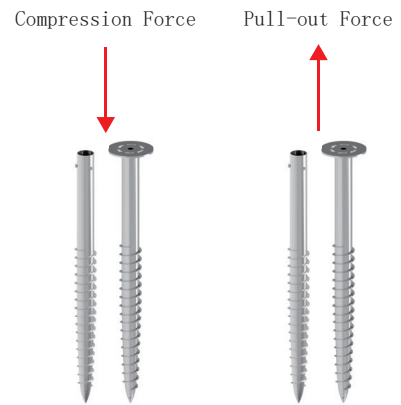

Ground Screw Spec	Soil Type	Force Value Type/Soil N Value	N Value=3	N Value=4	N Value=5	N Value=6	N Value=7	N Value=8	N Value=9	N Value=10
Ground Screw Φ76*1200 (surface elevation 200mm)	Clay	Maximum Pull-out Resistance (KN)	3.340	4.436	5.531	6.627	7.723	8.818	9.914	11.010
		Maximum Compression Support Force (KN)	4.110	5.480	6.850	8.220	9.590	10.960	12.330	13.700
Ground Screw Φ76*1600 (surface elevation 200mm)	Clay	Maximum Pull-out Resistance (KN)	5.017	6.665	8.314	9.962	11.611	13.259	14.908	16.557
		Maximum Compression Support Force (KN)	6.182	8.243	10.303	12.364	14.425	16.486	18.546	20.607
Ground Screw Φ76*1800 (surface elevation 200mm)	Clay	Maximum Pull-out Resistance (KN)	5.742	7.629	9.516	11.404	13.291	15.178	17.066	18.953
		Maximum Compression Support Force (KN)	7.077	9.437	11.796	14.155	16.514	18.873	23.591	24.510
Ground Screw Φ76*2000 (surface elevation 200mm)	Clay	Maximum Pull-out Resistance (KN)	6.693	8.895	11.096	13.298	15.499	17.701	19.902	22.103
		Maximum Compression Support Force (KN)	8.256	11.007	13.759	16.511	19.263	22.015	24.767	27.518
Ground Screw Φ76*2200 (surface elevation 200mm)	Clay	Maximum Pull-out Resistance (KN)	7.418	9.859	12.299	14.739	17.179	19.620	22.060	24.500
		Maximum Compression Support Force (KN)	9.151	12.201	15.251	18.302	21.352	24.402	27.453	30.503
Ground Screw Φ76*2500 (surface elevation 200mm)	Clay	Maximum Pull-out Resistance (KN)	8.506	11.304	14.103	16.901	19.700	22.498	25.296	28.095
		Maximum Compression Support Force (KN)	10.494	13.992	17.490	20.988	24.486	27.984	31.482	34.980
Ground Screw Φ76*3000 (surface elevation 200mm)	Clay	Maximum Pull-out Resistance (KN)	10.319	13.714	17.110	20.505	23.900	27.295	30.691	34.086
		Maximum Compression Support Force (KN)	12.730	16.980	21.220	25.460	29.710	33.950	38.200	42.440

OTHER SPECIFICATIONS



Name fo Product : SPIRAL BLADE GROUND SCREW (with flange)

Product Number : SE-HB76-1600F-T3.0

Material: Carbon Steel (Q235B/ISO 630 Fe360D)

Galvanized Layer 80µm or more

Length: 1600mm

Pile Pipe Outer Diameter: 76mm

Pile Pipe Inner Diameter: 70mm

Pile Pipe Thickness: 3.0mm



Name fo Product : DOUBLE BLADE GROUND SCREW
(with flange)

Product Number : SE-GS76-1600F-T3.0

Material: Carbon Steel (Q235B/ISO 630 Fe360D)

Galvanized Layer 80µm or more

Length: 1600mm

Pile Pipe Outer Diameter: 76mm

Pile Pipe Inner Diameter: 70mm

Pile Pipe Thickness: 3.0mm

Blade Diameter 176mm Thickness 5mm



Name fo Product : SE GROUND SCREW (without flange)

Product Number : SE-GS76-1600N-T3.0

Material: Carbon Steel (Q235B/ISO 630 Fe360D)

Galvanized Layer 80µm or more

Length: 1600mm

Pile Pipe Outer Diameter: 76mm

Pile Pipe Inner Diameter: 70mm

Pile Pipe Thickness: 3.0mm



Name fo Product : HEIGHTENING GROUND SCREW
(with double flanges)

Product Number : SE-DF76-500-T3.0

Material: Carbon Steel (Q235B/ISO 630 Fe360D)

Galvanized Layer 80µm or more

Length: 500mm

Pile Pipe Outer Diameter: 76mm

Pile Pipe Inner Diameter: 70mm

Pile Pipe Thickness: 3.0mm

*length, thickness, pile diameter can be customized